

TIMBER APPRAISAL REPORT



Permit Holder	Sale Type	RAN	Permit Number
	Intermediate Auction	253	X019723
	Permit Date	Expiration Date	
	02/07/2025	05/31/2029	

Minnesota DNR is Certified to the Sustainable Forestry Initiative® and/or the Forest Stewardship Council®.
 For information on our certificates go to mndnr.gov/forestry/certification/certificates.html

Appraisal includes one (1) cutting block:

Block #	Legal Description	Sec-Twp-Rng	County
1	GL09, GL10 GL01, NENE, SENE, SWNE	1-57-11W 12-57-11W	38: Lake

Species/Products/Price (all quantities are estimates):

Bid	SOAV	Species	Product	Quantity	UOM	Appraised Price	Appraised Value	Bid %	Bid Price	Bid Value
+		Mixed Spruce	Pulp & Bolts	270.00	Cd	10.53	2,843.10		10.53	2,843.10
+		Tamarack	Pulp & Bolts	50.00	Cd	4.88	244.00		4.88	244.00

Sale Acres	23.9	Advance Payment	463.07	Total Appraised Value	3,087.10	Total Bid Value	0.00
------------	------	-----------------	--------	-----------------------	----------	-----------------	------

Top Diameter Utilization: Unless otherwise specified, each species product must be utilized down to a minimum merchantable top diameter inside bark (dib) as follows: woodsrun cordwood and pulpwood to 4 inches, except spruce to 3 inches; bolts to 6 inches; sawtimber to 10 inches; and veneer to 14 inches.

Optional Timber (may be purchased with an Added Timber Agreement):

SOAV	Species	Product	Quantity	UOM	Appraised Price	Appraised Value
	Any Listed Species	Biomass	305.00	Tons	0.65	198.25

Total Appraised Cords per Acre: 13.4

Mixed Species Description:

Mixed Spruce Pulp & Bolts includes White Spruce 40%; Black Spruce 60%.

Mixed Product Description:

Tamarack Pulp & Bolts includes Bolts 25%; Pulpwood 75%.
 Mixed Spruce Pulp & Bolts includes Bolts 40%; Pulpwood 60%.

HARVEST SPECIFICATIONS

Cutting and Felling:

- Harvest spruce and tamarack.
- Reserve areas indicated on map and painted blue.
- Fell all live black spruce equal to or greater than 5 feet tall.

Season of Operations:

- Conduct Sale operations on frozen soil conditions only, except with written permission from State.

Slash Disposal:

- Lop and scatter slash evenly over the harvest site to within 4 feet of the ground.
- If biomass is purchased with an Added Timber Agreement, 20% of the tops and limbs must be left on the site or hauled back from the landing and redistributed in the general harvest area. This percentage may be adjusted up or down to meet the 1/3 retention goal if incidental breakage is more or less than 10-15%.

TIMBER APPRAISAL REPORT - HARVEST SPECIFICATIONS (continued)

Site, Soil, and Water Protection:

- If site damage becomes apparent, alter or cease operations and contact State.

Landings, Roads, and Trails:

- The location and construction of all roads and landings must be pre-approved by the State.
- Road right of way crossing approval from county may be required.

Sale Conditions:

- Access is across State land.
- Access crosses Public Waters. A Permit is not required if using a snow / ice bridge.
- Provisions of access and /or water crossing permits will become part of sale terms and conditions for this sale.

Marketing and Special Conditions:

Mixed Spruce Pulp & Bolts: Average 8" DBH and 4 sticks
Tamarack Pulp & Bolts: Average 9" DBH and 3 sticks

Tree sizes are averages based on field estimates, actual sizes will vary larger or smaller.

Sale is located 29.8 miles North of Two Harbors, adjacent to Upland Lake. Most of the harvest area is lowland. Spruce bolts are mostly in white spruce stand. Sale is affected by spruce budworm and dwarf mistletoe. White spruce stand has approximately 12 cds/ac of standing dead spruce that has been added to biomass volume, if not being utilized it may be cut and piled for access to timber. Access may include .1 mile of new construction with merchantable timber, .5 mile new construction without timber, and .25 mile old winter road. Spruce and tamarack received -35% Lake County discount.

Price Adjustments:

- Road Construction Costs: -10%
- Haul Distance to Nearest Mill: -15%
- Stand Density: -10%
- Operational Constraints: 0%
- Other Price Factor: -35% (Lake County)

Permits Required:

(None)

Forestry Area Office:

Two Harbors Area Forestry Office
1568 Highway 2
Two Harbors, MN 55616
Telephone: 218-834-1420

Appraiser Signature	Appraiser (Printed name) Brian Schiller	Appraiser ID # 01165593	Signature Date 12/05/2024
Approved By Signature	Approved By (Printed name) Jason Bushmaker	Approver ID # 01118506	Approval Date 12/05/2024



Permit Holder	Sale Type	RAN	Permit Number
	Intermediate Auction	253	X019723
Permit Date		Expiration Date	
02/07/2025		05/31/2029	

Legal Description	Sec-Twp-Rng	County
GL09, GL10 GL01, NENE, SENE, SWNE	1-57-11W 12-57-11W	38: Lake

GPS Location: Latitude 47 26 40, Longitude -91 39 24

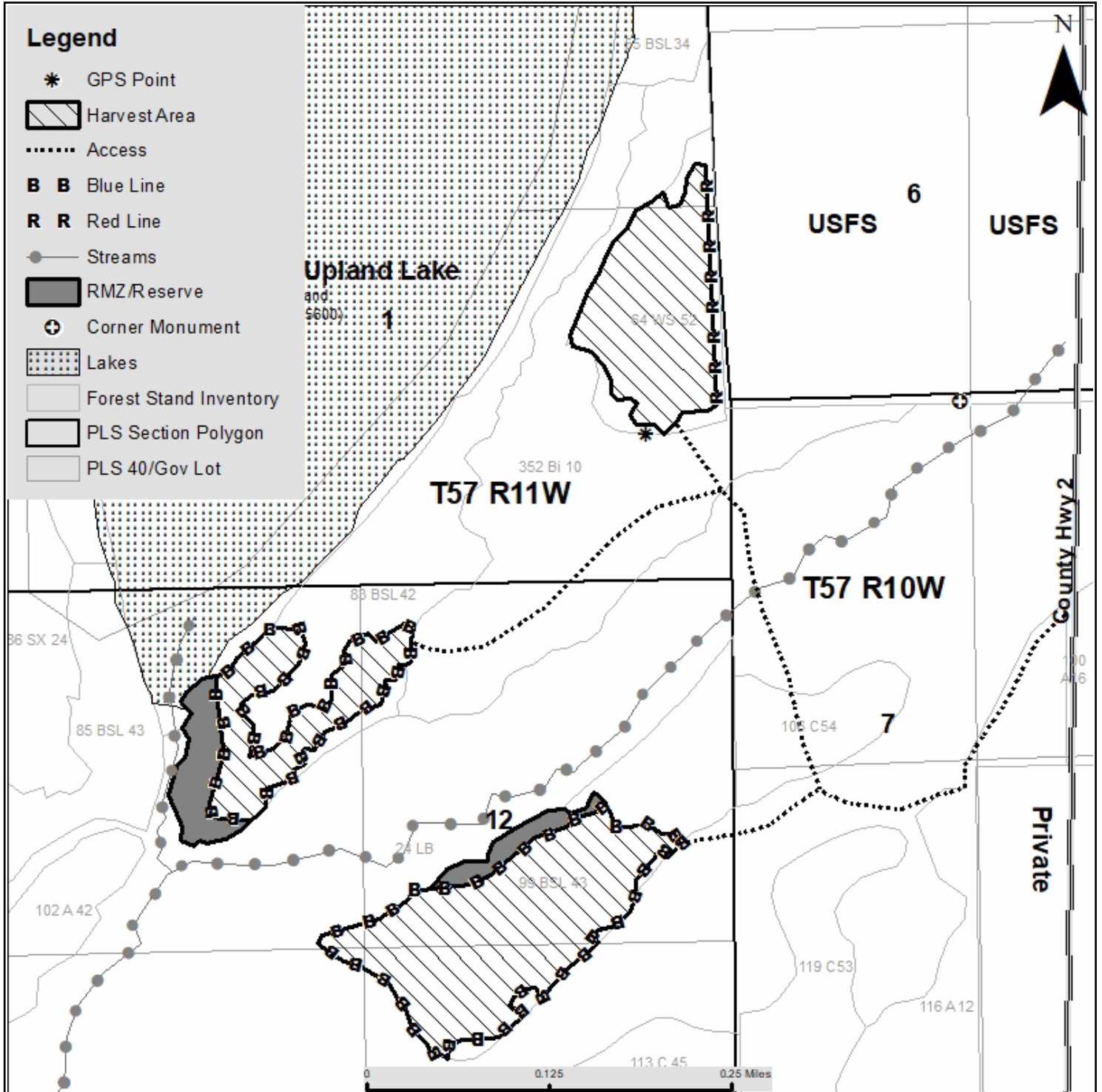

(Cutting Block 22990, Snapshot Sequence Number 0)

Cutting Block Map (may not print to scale)

SOAV Eligible: No

Stand Management Information - Appraisal only includes one (1) cutting block:

Site t05711w1010064	Harvest Prescription Regen Harvest-Even-Aged-Salvage-w/Rsrv Clearcut I&D						
Stand	Cover Type	Plan Status	Planned	Examined	Appraised	Deferred	Altered
t05711w1010064	WS	Adopted	9.1	9.1	7.3	0.0	1.8

Site t05711w120083	Harvest Prescription Regen Harvest-Even-Aged-Salvage-w/Rsrv Clearcut I&D						
Stand	Cover Type	Plan Status	Planned	Examined	Appraised	Deferred	Altered
t05711w120083	BSL	Adopted	19.6	19.6	6.9	0.0	12.7

Site t05711w120099	Harvest Prescription Regen Harvest-Even-Aged-Salvage-w/Rsrv Clearcut I&D						
Stand	Cover Type	Plan Status	Planned	Examined	Appraised	Deferred	Altered
t05711w120099	BSL	Adopted	17.2	17.2	12.6	0.0	4.6

Totals	45.9	45.9	26.8	0.0	19.1
---------------	-------------	-------------	-------------	------------	-------------

Forty/Lot Information:

Twp - Range	Sec	Forty / Lot	Land Status	Acres	% Total Value
57-11W	1	GL09	09: School	7.0	29
		GL10	09: School	0.3	1
57-11W	12	GL01	09: School	4.4	18
		NENE	09: School	7.6	32
		SENE	09: School	4.5	19
		SWNE	09: School	0.1	1

Totals	23.9	100
---------------	-------------	------------

Specifications included in Notice Of Sale:

Cutting and Felling:

- Fell all live black spruce equal to or greater than 5 feet tall.

Season of Operations:

- Conduct Sale operations on frozen soil conditions only, except with written permission from State.

Sale Conditions:

- Access is across State land.
- Access crosses Public Waters. A Permit is not required if using a snow / ice bridge.
- Provisions of access and /or water crossing permits will become part of sale terms and conditions for this sale.